

Features

- ISO-6432 standard.
- Stainless steel rod and tube for good corrosion resistance.
- Comprehensive types of mounting accessories available.
- Hexagonal rod design provides rod non-rotation function.

Specification

Model	MCKMI			
Tube I.D. (mm)	16	20	25	
Port size	M5×0.8	G1/8		
Medium	Air			
Operating pressure range	0.06~0.7 MPa			
Proof pressure	1 MPa			
Lubricator	Not required			
Ambient temperature	-5°C~+60°C (No freezing)			
Available speed range	50~500 mm/sec			
Max. allowable kinetic energy (J)	Cushion pad	0.09	0.27	0.4
	Cushion air	—	0.66	0.97
Rod non-rotating accuracy	±1°	±0.7°		
Allowable rotational torque	0.4 kgf-cm	2.0 kgf-cm	2.5 kgf-cm	
Sensor switch (band) (*1)	RCM(BM16)	RCM(BM20)	RCM(BM25)	

Table for standard stroke

Tube I.D.	Stroke (mm)
ø16	15,25,50,75,100,125,150,200
ø20,25	15,25,50,75,100,125,150,200,250,300

- Please consult us if stroke out of specification.

Tightening torque

Tube I.D.	Rod thread	Tightening torque (kgf-cm)
ø16	M6×1.0	41
ø20	M8×1.25	100
ø25	M10×1.25	190

* Make sure the tightening torque of rod thread does not exceed the value above.

* The tolerance of tightening torque is ±5%.

Order example

MCKMI — 11 — 20 — 100 — A — N

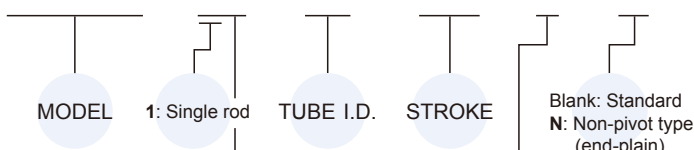

Code	Symbol	Description
1 1		Double acting / Male thread

Blank: Cushion pad (Unadjustable)
A: Cushion air (Adjustable) ⚠
 (Only for ø20, 25)

⚠ Caution

For (A) Cushion air (Adjustable)

1. To adjust a cushion needle, please slowly turn the needle valve from the fully closed status to the required status whose turns need to be within 2.5 circles.
2. If the needle valve loosens excessively, the buffer can't take effect and the lifetime of cylinder can shorten.

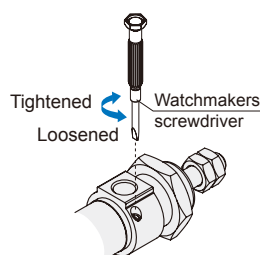

Mounting accessories

FA — MCKMI — 20

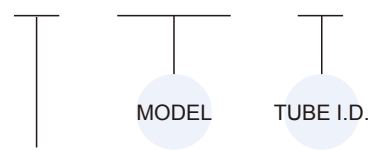

MOUNTING TYPE

	LB
	FA
	FB
	SDB
	Y
	I
	YS (Y+Floating pin)

* Use the same accessories with MCKMI.

* Y, I, YS, please refer to page 3-13.

Cushion pad

Unadjustable

$\phi 16, \phi 20$

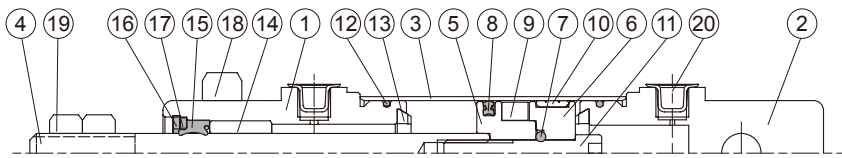

$\phi 25$

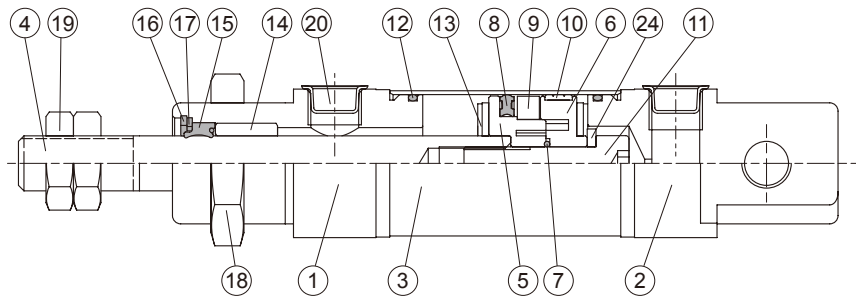

N type

Cushion air

Adjustable

$\phi 20, \phi 25$

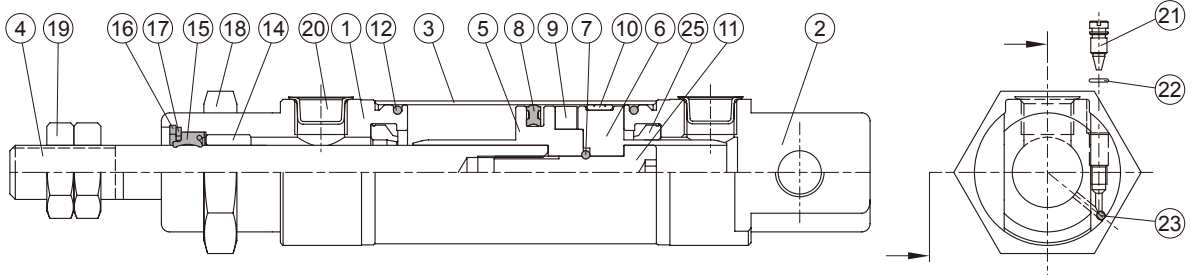

Material

No.	Cushion		Part name	Tube I.D.			Q'y
	Pad	Air		16	20	25	
1	●	●	Rod cover	Aluminum alloy			1
2	●	●	Head cover	Aluminum alloy			1
3	●	●	Tube	Stainless steel			1
4	●	●	Piston rod	Stainless steel			1
5	●	●	Piston-R	Aluminum alloy			1
6	●	●	Piston-H	Aluminum alloy			1
7	●	●	Piston gasket	NBR			1
8	●	●	Piston packing	NBR			1
9	●	●	Magnet ring	Magnet material			1
10	●	●	Wear ring	Teflon+Graphite			1
11	●	●	Piston bolt	SCM			1
12	●		Cover ring	NBR			2
13	●	●	Cushion gasket	NBR	TPU		2
14	●	●	Rod bush	Bearing alloy			1

No.	Cushion		Part name	Tube I.D.			Q'y
	Pad	Air		16	20	25	
15	●	●	Rod packing	NBR			1
16	●	●	Snap ring	Spring steel			1
17	●	●	Washer	Carbon steel			1
18	●	●	Tie nut	Carbon steel			1
19	●	●	Rod front nut	Carbon steel			2
20	●	●	Port plug	Plastic			2
21		●	Needle valve	Stainless steel			2
22		●	Needle valve packing	NBR			2
23		●	Steel ball	Stainless steel			2
24	●		washer	—		*	1
25		●	Cushion packing	NBR			2

* Carbon steel

11

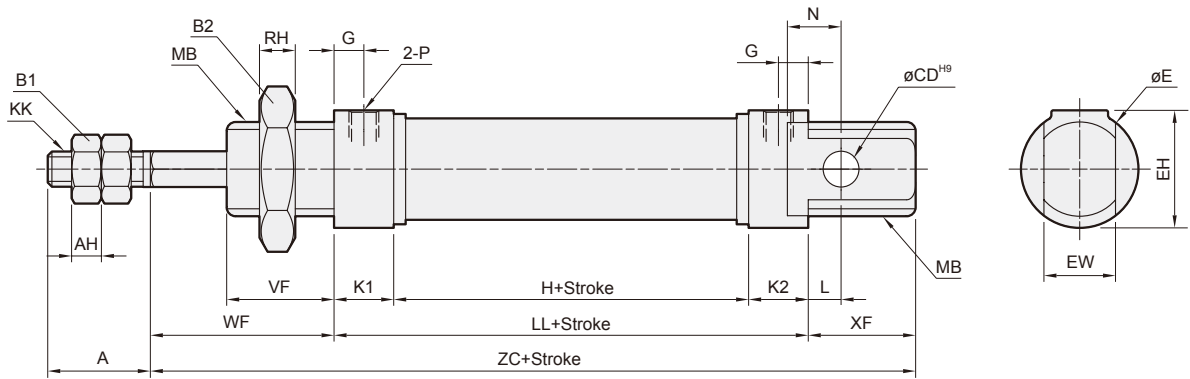

N

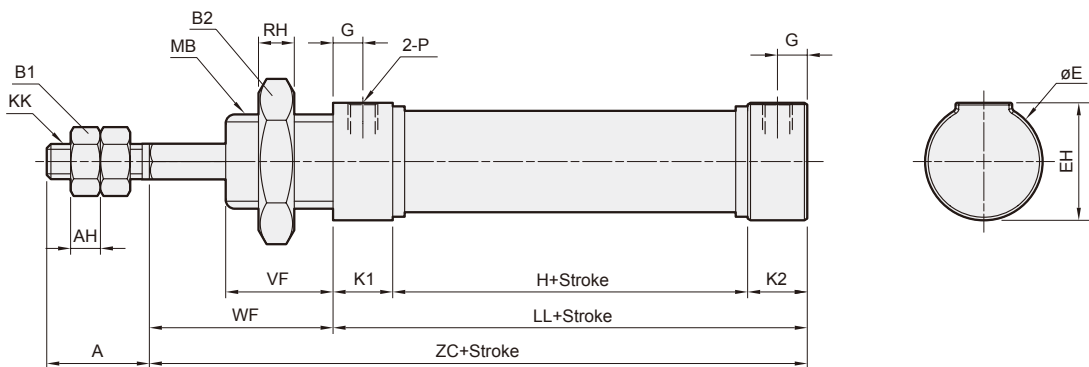

Code Tube I.D.	A	AH	B1	B2	CD	E	EH	EW	G	H	KK	K1	K2	L	LL	MB	N	P	RH	VF
16	16	5	10	22	6	20	20	12 ^{-0.05} _{-0.4}	5	34.5	M6×1	10	10	5.5	54.5	M16×1.5	9	M5×0.8	6	18
20	20	5	13	30	8	27	27	16 ^{-0.05} _{-0.4}	8	38	M8×1.25	15	15	3	68	M22×1.5	12	G1/8	6	20
25	22	6	17	30	8	27	27	16 ^{-0.05} _{-0.4}	7.5	37	M10×1.25	15	15	9	67	M22×1.5	12	G1/8	6	22

Code Tube I.D.	WF	XC	XF	ZC
16	22	76.5	18	94.5
20	24	92	20	112
25	28	95	22	117

Cylinder weight

Unit: g

Model	Basic weight MCKMI	Stroke 25mm MCKMI	Basic weight MCKMI-*N	Stroke 25mm MCKMI-*N
Tube I.D.				
$\phi 16$	69	13.0	62	13.0
$\phi 20$	126	20.3	116	20.3
$\phi 25$	168	28.7	153	28.7